

# NS 35/ 7,5 PERF 2000MM NZ REF CUT-VPE 10 - DIN rail perforated



0843110

<https://www.phoenixcontact.com/us/products/0843110>

Please be informed that the data shown in this PDF document is generated from our online catalog. Please find the complete data in the user documentation. Our general terms of use for downloads are valid.



DIN rail perforated, Pack of 10 (20 m), acc. to EN 60715, material: Steel, galvanized, passivated with a thick layer, Standard profile, color: silver

## Commercial data

Item number	0843110
Packing unit	1 m
Minimum order quantity	10 m
Sales key	BE72
Product key	BE7238
GTIN	4046356949118
Weight per piece (including packing)	670 g
Weight per piece (excluding packing)	670 g
Customs tariff number	72166190
Country of origin	DE

# NS 35/ 7,5 PERF 2000MM NZ REF CUT-VPE 10 - DIN rail perforated



0843110

<https://www.phoenixcontact.com/us/products/0843110>

## Technical data

### Product properties

Product type	DIN rail
--------------	----------

### Dimensions

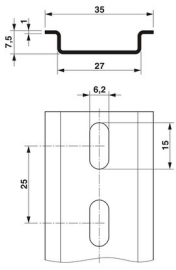
Dimensional drawing	
Width	35 mm
Hole width	15 mm
Height	2000 mm
Hole height	6.2 mm
Depth	7.5 mm
Length	2000 mm
Drill hole spacing	25 mm
Diameter	6.2 mm

### Material specifications

Color	silver
Material	Steel
Coating	galvanized, passivated with a thick layer

### Standards and regulations

Connection in acc. with standard	IEC / EN
Tests	acc. to EN 60715

# NS 35/ 7,5 PERF 2000MM NZ REF CUT-VPE 10 - DIN rail perforated



0843110

<https://www.phoenixcontact.com/us/products/0843110>

## Drawings

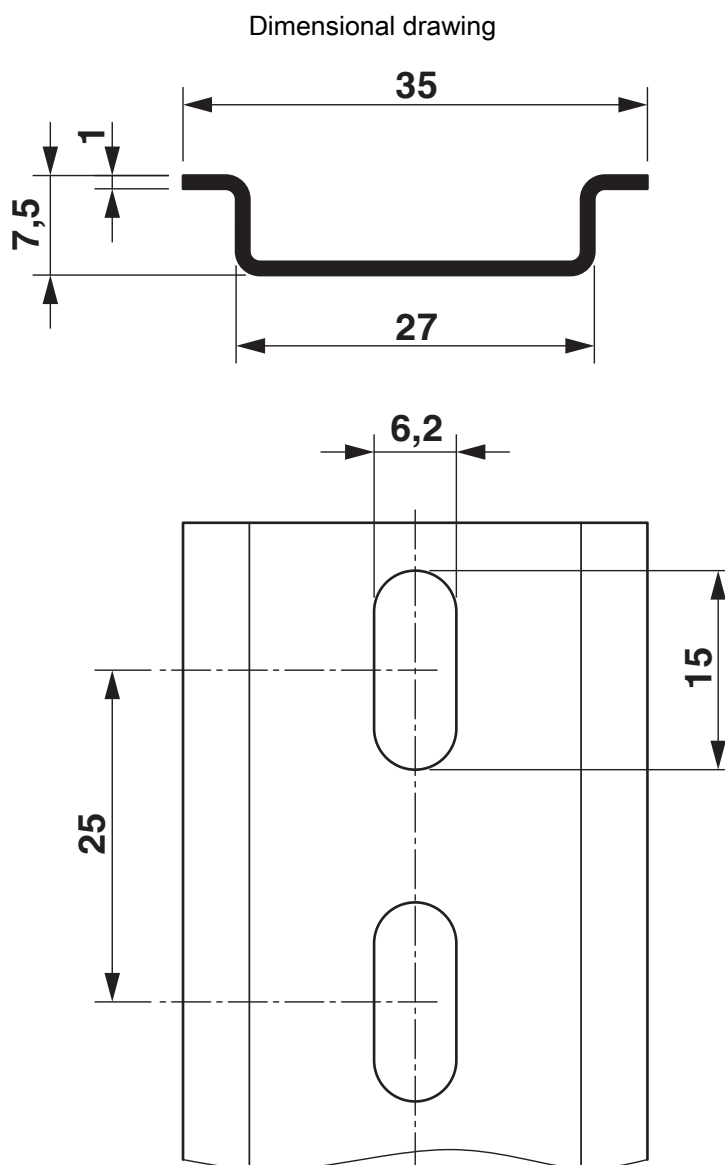

# NS 35/ 7,5 PERF 2000MM NZ REF CUT-VPE 10 - DIN rail perforated



0843110

<https://www.phoenixcontact.com/us/products/0843110>

## Classifications

### ECLASS

ECLASS-11.0	27400602
ECLASS-12.0	27400602
ECLASS-13.0	27400602

### ETIM

ETIM 8.0	EC001285
----------	----------

### UNSPSC

UNSPSC 21.0	39121700
-------------	----------

Phoenix Contact 2023 © - all rights reserved  
<https://www.phoenixcontact.com>

Phoenix Contact USA  
586 Fulling Mill Road  
Middletown, PA 17057, United States  
(+717) 944-1300  
[info@phoenixcon.com](mailto:info@phoenixcon.com)